



“Phase I” Funding Program

Hospital in Sudan for Padang Lutheran Christian Relief

Project Background:

Like many African war torn countries, Southern Sudan has barely any hospitals to actually meet the demand for medical services to its populations. As peace has been signed in 2005, five million refugees are now returning to their ancestral homeland in Southern Sudan.

Due to the epidemic diseases in this area, there is urgent need for medical facility that provides more than basic care. For that reason, Padang Lutheran Christian Relief has planned Kon Mamor Memorial Hospital to be built in Nyongrial Payam with the aim to give more attention to particularly quality medical services for children, women and men in Southern Sudan.

PLCR is eager to see that project to take place as soon as possible. This medical facility will help to reduce child mortality, improve maternal health, combat malaria, cholera and other diseases borne out of poverty.

PLCR is located in Vancouver in Canada with field office in Malakal in Southern Sudan and the project presented here is to build the most immediately needed medical facility as a support for the Medical programs, namely an Out-Patient Clinic plus a Community Health Unit, to serve as a base in the area where programs are carried out. Those two buildings have been planned in such a way that they later can become the initial facility for a full 120 Bed Hospital to be functioning as a referral hospital for the entire population of Baliet County in Southern Sudan.

Project Design:

A bird's eye perspective of most of the full hospital project is shown on the back of this sheet. Further, floor plans are shown for the planned initial two buildings, an Out-Patient Department, which will initially function as a Dispensary, as well as a Community Health Unit. A portion of the site plan is also included to show the relation between the two buildings. With those two Buildings (Out-Patient Department on 285m² plus the Community Health Unit on 125m²) the new medical facility will be able to start giving compassionate health care services to the community of Nyongrial Payam in Southern Sudan.

Project Cost:

PLCR is seeking sponsors to fund the initial first Phase of this Hospital project. More detailed cost estimates for the full hospital project can be provided. But with new construction cost in South Sudan being higher than in the majority of other African countries (due to the situation there) this project can be realized for the following cost:

| | |
|--|----------------------------|
| Total cost in Sudan (including fees and misc. expenses) for two buildings plus barbed wire fencing with gates around site | \$ 250,000/= |
| Less approx. 10% for self-help portion in form of volunteer labor and/or building materials obtained locally | <u>\$ 25,000/=</u> |
| Balance | \$ 225,000/= |
| Add approx. 4% of that for fees and cost to administer project | <u>\$ 9,000/=</u> |
| Total required financial assistance for this Project | <u>\$ 234,000/=</u> |

Funding assistance for this project is tax deductible and is to be channeled through MSAADA at the below written address:

518-122 Franklin Avenue, West
Minneapolis, MN 55404 USA

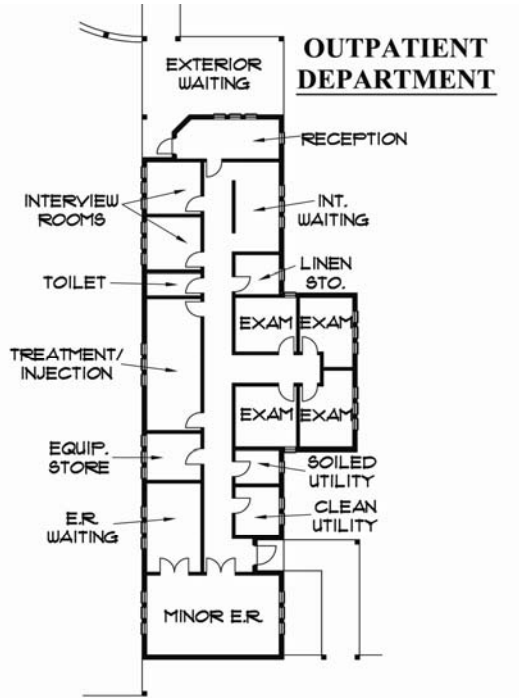

PROJECT:

PHASE 1 FOR HOSPITAL IN SUDAN FOR PADANG LUTHERAN CHRISTIAN RELIEF

AREAS

| | |
|-----------------------|-------------------------|
| Out-Patient Dept. | 285m ² |
| Community Health Unit | 125m ² |
| TOTAL | 410m² |

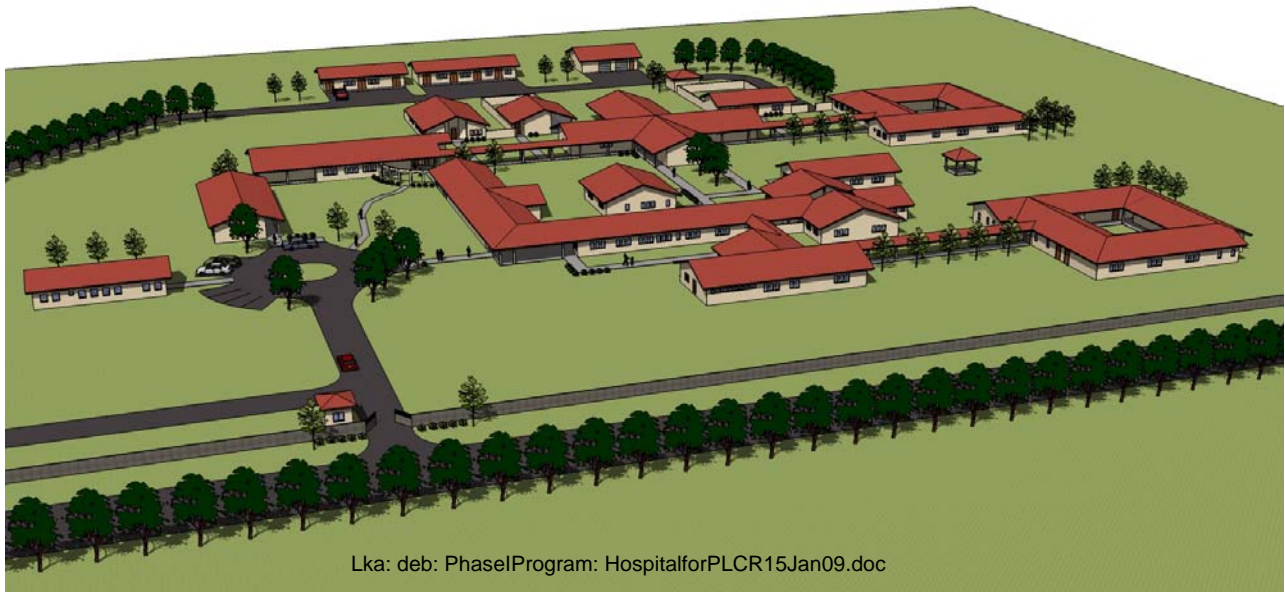
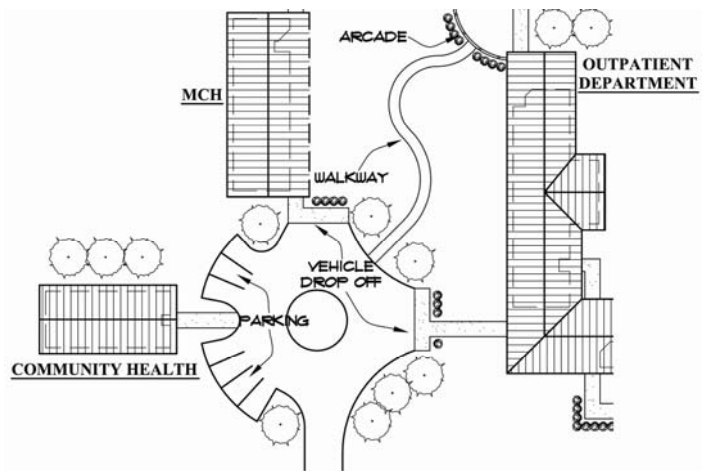

Lka: deb: PhaselProgram: HospitalforPLCR15Jan09.doc